

CONTENTS

- 1 Stop, door - transitional and professional
- 1 Stop, door - contemporary

TRANSITIONAL AND PROFESSIONAL INSTALLATION

- 1 Place the door stop in the center vent opening directly below the control panel.

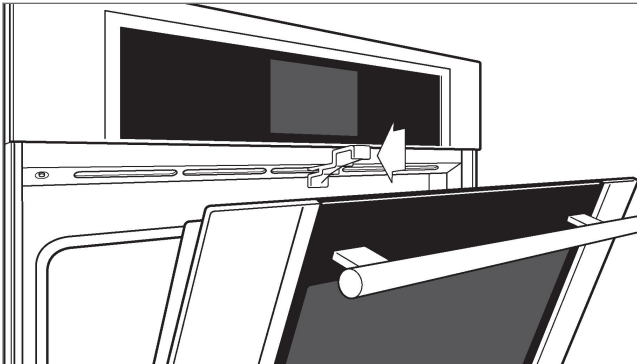

- 2 Once installed, allow the door to close until it contacts the stop.

CONTEMPORARY INSTALLATION

- 1 Place the door stop on the center of the door glass.

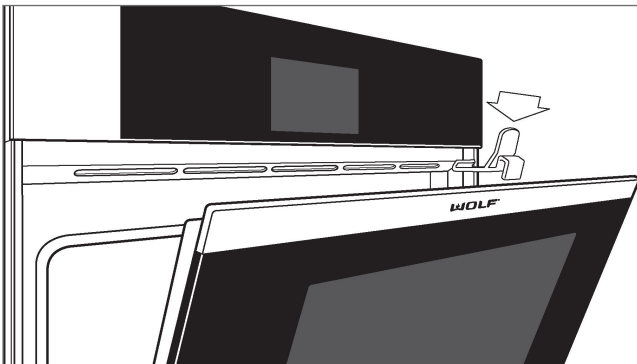

- 2 Once installed, push the door closed until the door stop is engaged.
- 3 To open, press the tab on the door stop.

